



PORTABLE RV WASTE PUMP

WELCOME TO THE FAMILY!



Thanks for purchasing the LATCH.IT RV Macerator Pump!
We are a family owned American business that
cares about your RV needs!



Please review, read and understand ALL instructions to ensure proper
functionality.

If you have any questions or concerns, don't hesitate to reach out to us,
we are always available at info@latchit.org

PACKAGE CONTENTS

- RV Macerator Pump
- 1" Diameter Hose
- Metal Adjustable Clamps
- NPT Fittings
- 1" Female Fittings
- Power Wires & Plugs
- Carry & Storage Bag
- User Manual

TABLE OF CONTENTS.

01

TECHNICAL DIMENSIONS

02

TECHNICAL SPECIFICATIONS

03

APPLICATION

05

CONNECTING TO POWER

06

WIRING & OPERATION INSTRUCTIONS

08

MAINTENANCE

09

TROUBLESHOOTING

TECHNICAL DIMENSIONS

01

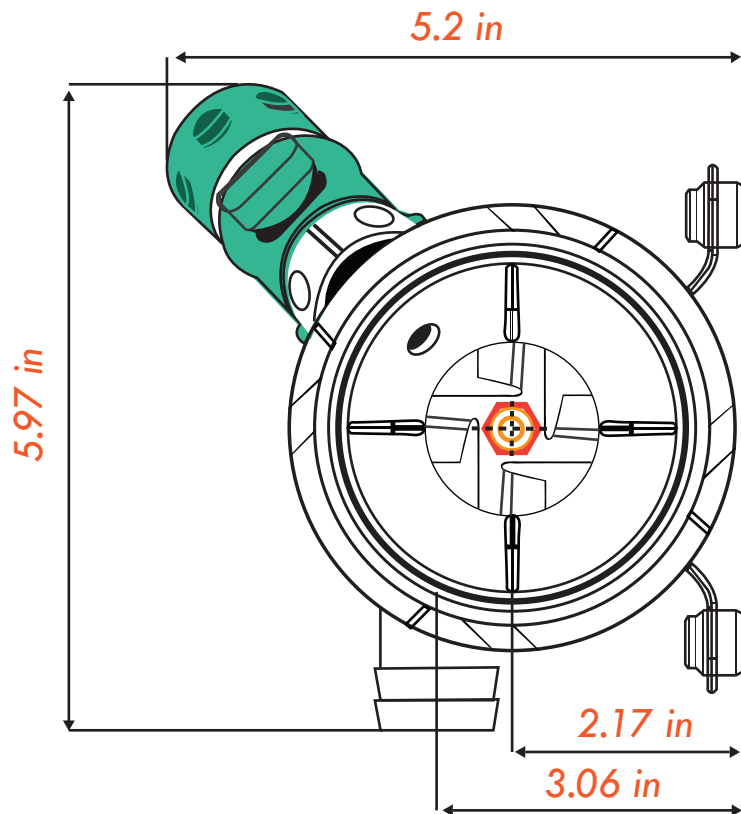
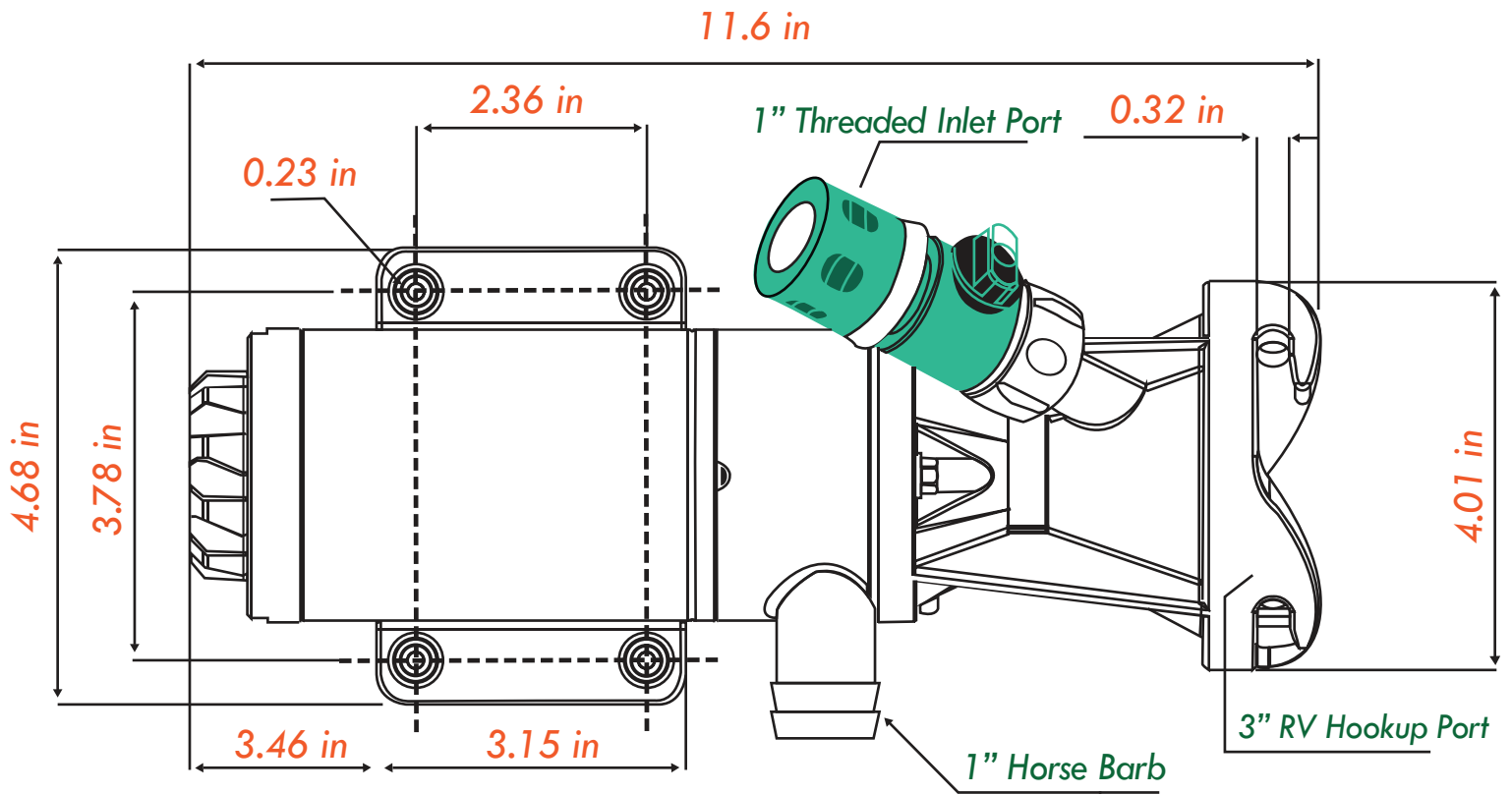

PUMP	Self-Priming Flexible Impeller with Stainless Steel Wear plate
IMPELLER	Jabsco Nitrile Compound
MACERATOR	Stainless Steel Cutter reduces particle size to ~1/8"
FLOWRATE	12.7 GPM

PORTS

Inlet #1 – 3" RV Connector
 Inlet #2 – 1" Water Inlet Hose
 Outlet – 1" Garden Hose Barb Connection

MOTOR

Power: 12 VDC
 ✓ Fully Enclosed, with Stainless Steel Shaft
 ✓ Intermittent Duty Only
Weight: 5.4 Lb.

WARNINGS AND NOTICES

- ⚠ DO NOT RUN DRY FOR MORE THAN 30 SECONDS.
- ⚠ DO NOT MOUNT PERMANENTLY TO THE RV WASTE PORT.
- ⚠ DO NOT RUN FOR MORE THAN 15 MINUTES CONTINUOUSLY
- ⚠ DO NOT RUN HARD OR SOLID OBJECT THROUGH PUMP
- ⚠ DO NOT RUN SANITARY NAPKINS OR RAGS THROUGH PUMP

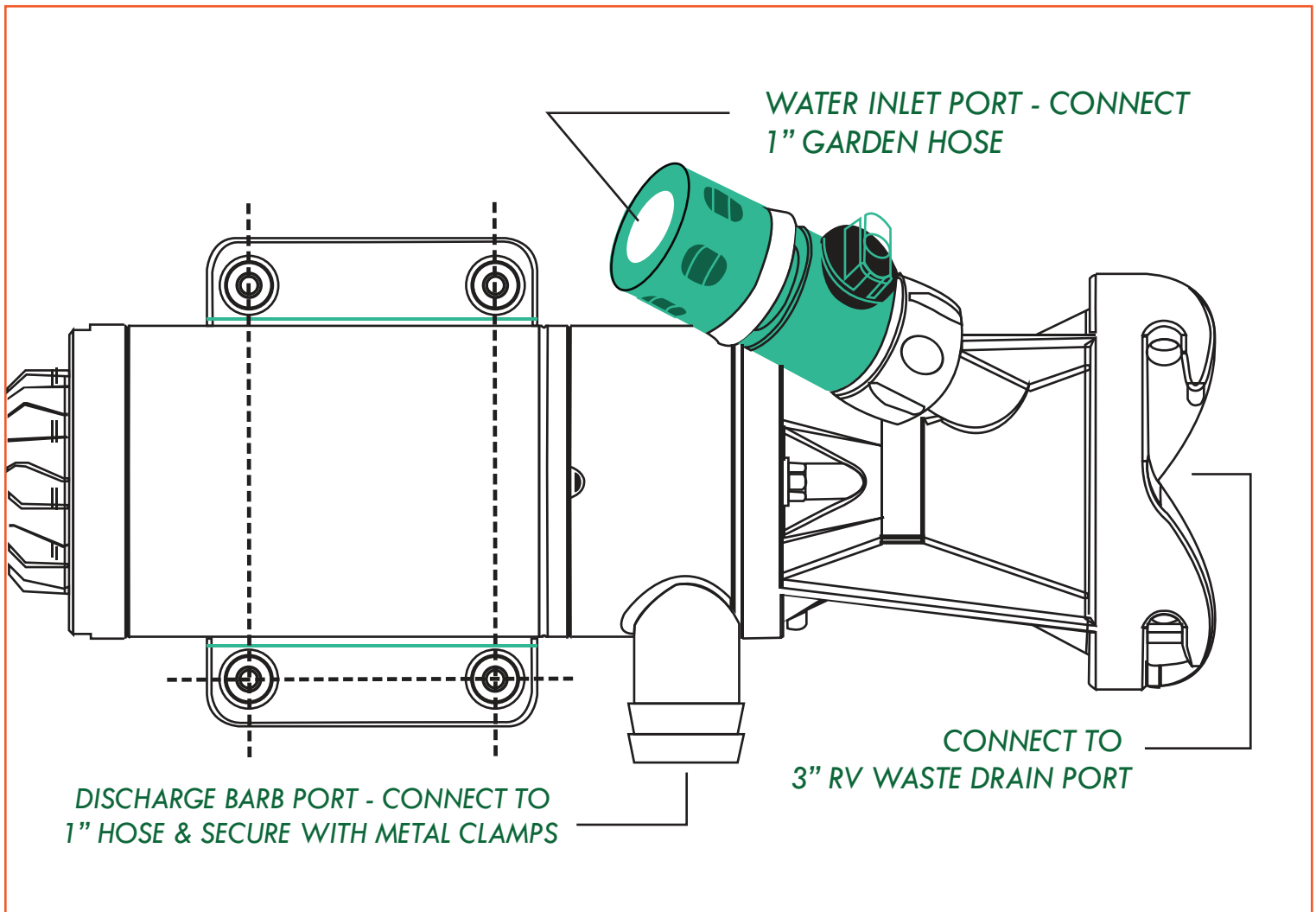

The LATCH.IT RV waste pump is the best solution for people always on the go. Empty out your holding tanks and avoid dumping stations. The macerator section of the LATCH.IT pump grinds down waste to a particle size of 1/8" so it can easily be pumped through a garden hose. Empty your holding tanks at a speed of 12.7 GPM!

NOTICE:

Please do not run for more than 15 minutes continuously.

The LATCH.IT RV waste pump will grind down most soft waste to a particle size of 1/8" and pump all waste normally found in recreational vehicle waste systems. It will not handle solid objects, sanitary napkins or rags.

RECOMMENDED HOSE SIZE FOR BEST PERFORMANCE

HOSE DIAMETER	MAXIMUM HOSE LENGTH
5/8"	25 feet
3/4"	50 feet

The recommended length is assuming the hose is laying down on a horizontal surface. We do not recommend running the maximum hose length on vertically elevated surfaces as it creates higher resistance and may result in the pump motor overheating.

The LATCH.IT RV Waste Pump comes with two power cables; this gives you the ability to connect to power 2 different ways depending on your choice. Each power cable comes with an ON/OFF switch to cycle power as required.

You can connect to 12VDC power via the red/black open wires.

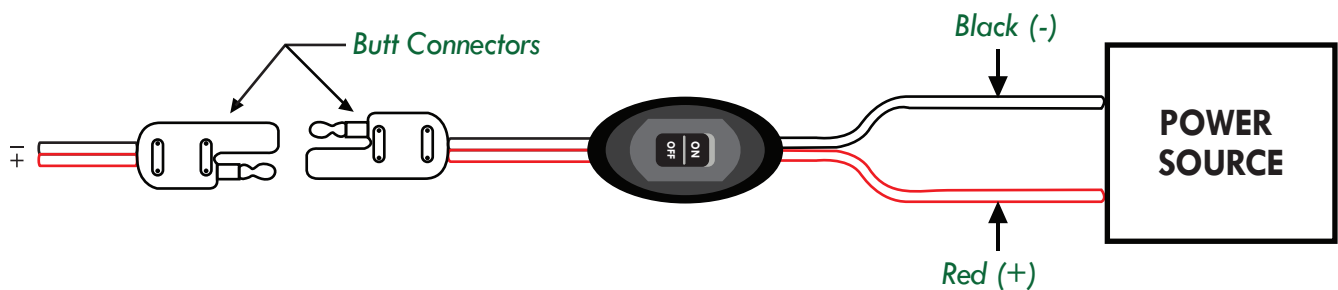

You can also connect to power directly to a car port charger.

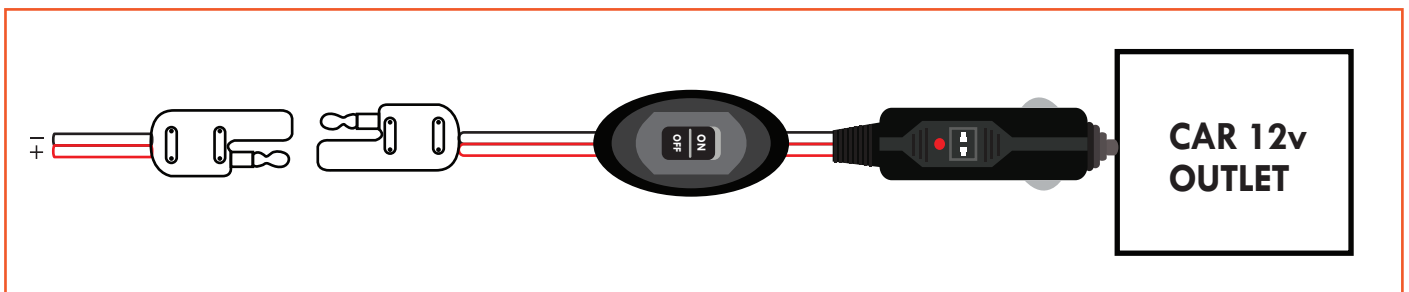

First connect the butt connector from the RV Waste Pump to the power wires of choice. Then find a suitable 12VDC Power Source and connect it.

Ensure ON/OFF switch is on the OFF position until you are ready to use the pump.

If using open ended wires, keep in mind black wire should be connected to a negative circuit or chassis ground while the red wire should be connected to a 12VDC power circuit.

WIRING DIAGRAM

06

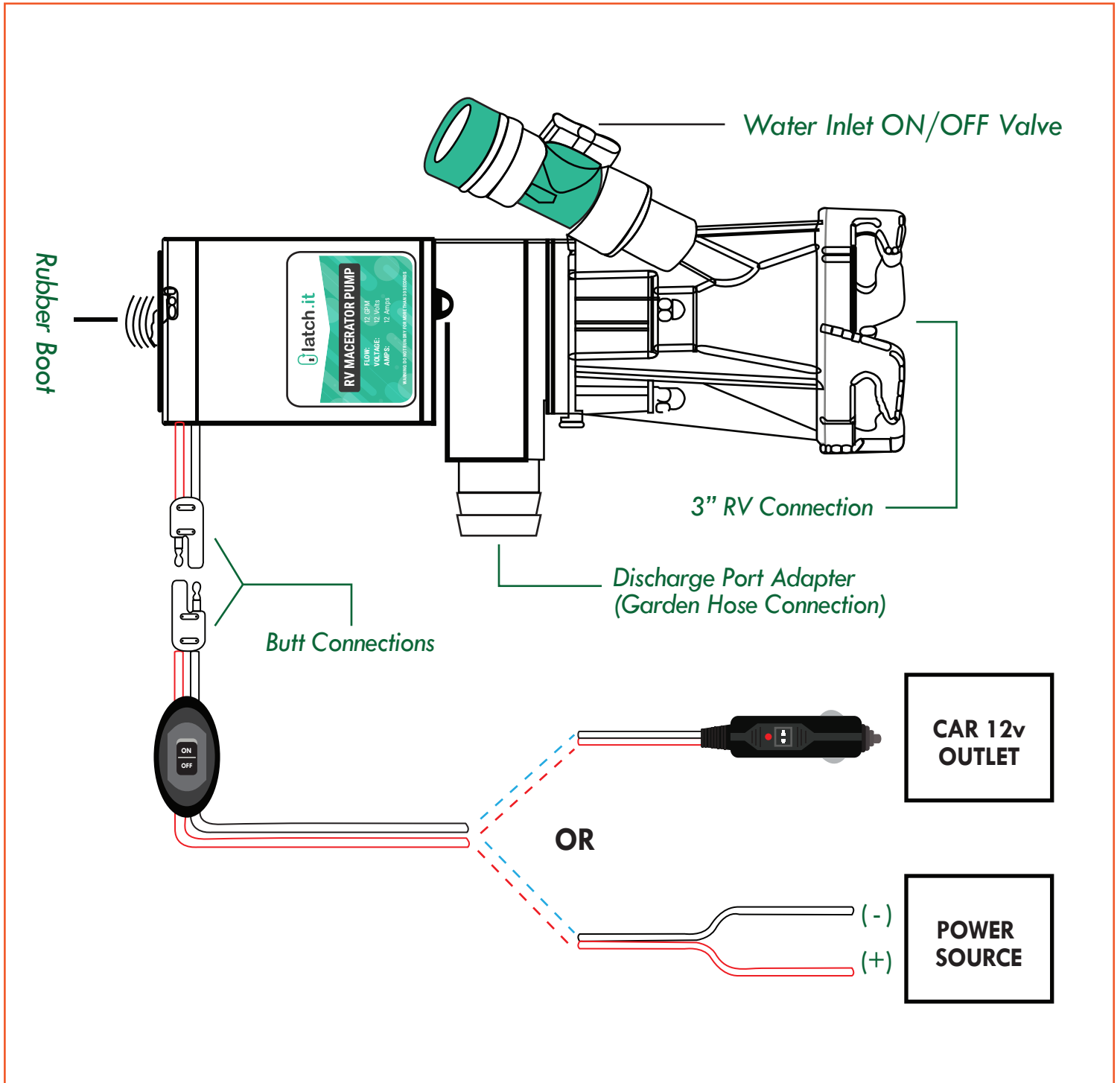

OPERATING INSTRUCTIONS

1. Remove Any Cover or Cap from RV drainpipe.
2. Before installing pump on RV, ensure the o-ring is in 3" RV pump adapter. You can see the o-ring in the inside lip of the 3" port.
3. Install the LATCH.IT waste pump on RV drainpipe by twisting clockwise to lock.
4. Use provided extra barb adapters and metal clamps to secure your waste/garden hose on discharge port.
5. Install water inlet hose to on/off valve port. This is the colored fitting on the LATCH.IT Macerator Pump.
6. Open black water valve to let waste flow and turn on pump.
7. Turn off pump and open gray water valve. Let gray water back-flush black water tank and then turn on pump.
8. Turn off pump, open rinsing valve (on colored fitting) and back fill tanks for rinsing. Turn on pump. Turn off rinse water and drain tanks.
9. Lastly, to rinse pump and discharge hose, close both black & gray tank drain valves, open rinse valve to let water flow (40 PSI max.) and turn on pump. Rinse pump and discharge hose.
10. Turn off water and pump, disconnect hose and pump. Store until next use.
11. Put back on cover or cap removed on step #1 from drainpipe.

STUCK IMPELLER

Sometimes after long periods of inactivity, the impeller may get stuck due to waste inside. Don't worry, simply remove the rubber boot at the end of the LATCH.IT RV waste pump & use a flat head to turn it clockwise. This will instantly help it break loose. When done, don't forget to replace the rubber boot.

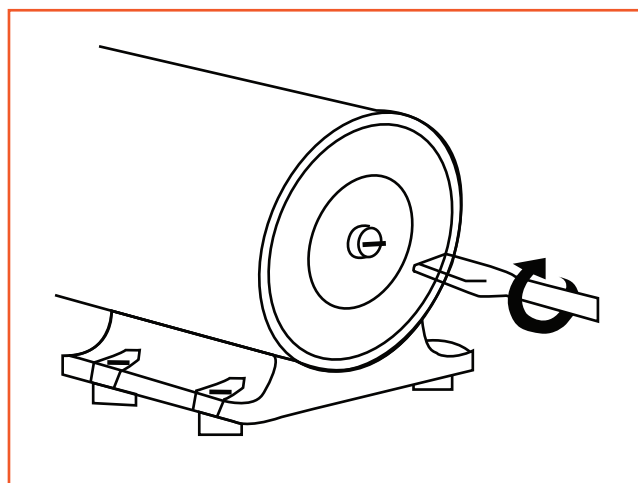

REPLACING FUSE

The fuse is located inside the ON/OFF switch on each power cable. To access it, remove the screws located on the back cover of the ON/OFF switch and exchange for a new fuse. The fuse size is written on the back cover of the ON/OFF switch.

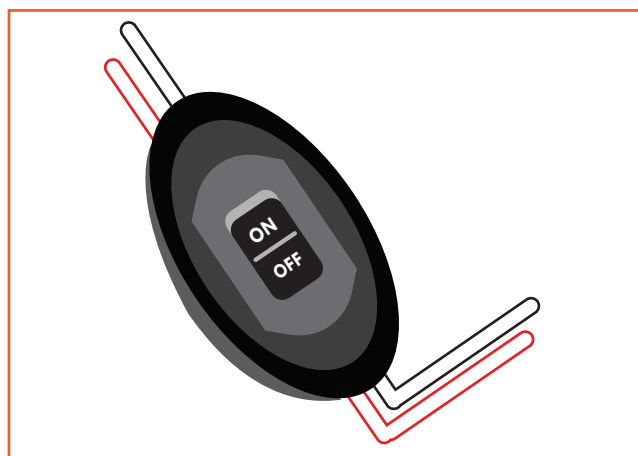

Oops! Something Went Wrong...
TROUBLESHOOTING

09

Scan with your smart phone camera to contact
LATCH.IT Support via the Official Website

www.latchit.org



Email us at info@latchit.org with any questions
or concerns, our support team is always available!



DO NOT RETURN OR SHIP **USED** PUMP. SEWAGE PUMPS
THAT HAVE BEEN IN SERVICE CARRY CONTAMINATION
FACTORS! CONTACT LATCH.IT SUPPORT.

